

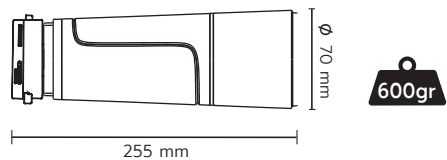

**20W**



INCLINAZIONE 0-180°  
INCLINATION 0-180°

ROTAZIONE 0-350°  
ROTATION 0-350°

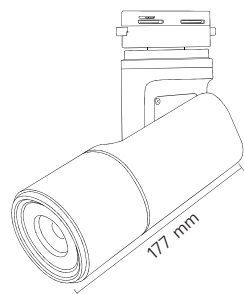

**35W**

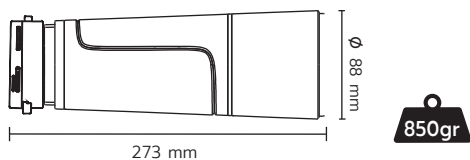

INCLINAZIONE 0-180°  
INCLINATION 0-180°

ROTAZIONE 0-350°  
ROTATION 0-350°

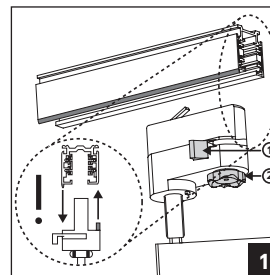
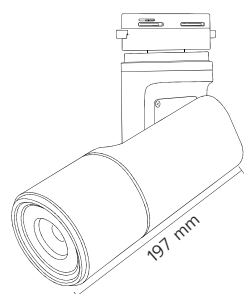

**IT** Posizionare come mostrato nel disegno. Interruttore di alimentazione in posizione "OFF". **IMPORTANTE!** - Assicurarsi che l'apparecchio sia montato nel verso giusto prima di impostare il fermo.

**GB** Shaft position as drawing shown. Power switch adjust to "OFF" position. **IMPORTANT!** - Ensure that the luminaire is mounted the right way round before setting the locking catch.

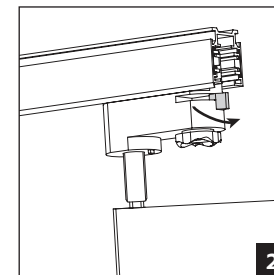

Posizionare come mostrato nel disegno.

Shaft position as drawing shown.

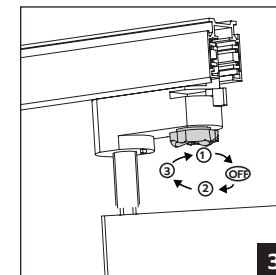

Regolare selezione per (OFF/1/2/3)

Adjust Selection to (OFF/1/2/3)

**Disinstallazione / Uninstall**

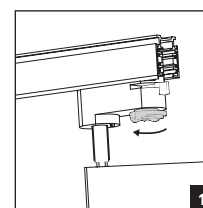

**IT** Interruttore di alimentazione posizionato su "OFF".

**GB** Power switch adjust to "OFF" position.

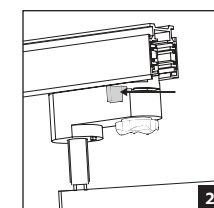

Posizionare come mostrato nel disegno.

Shaft adjust to drawing shown.

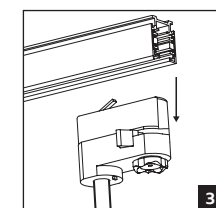

Disinstallazione

Disassembly of adaptor